

4
S4.0 TYPICAL PLATE SPLICE
SCALE: 3/4" = 1'-0"

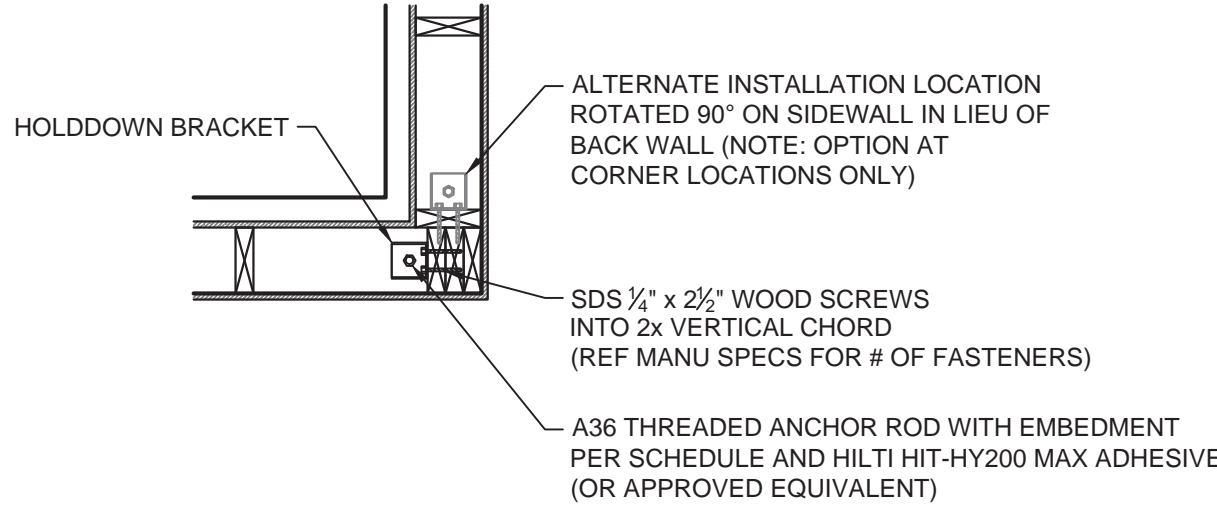

3
S4.0 TYPICAL HOLD DOWN ANCHOR PLAN
SCALE: 3/4" = 1'-0"

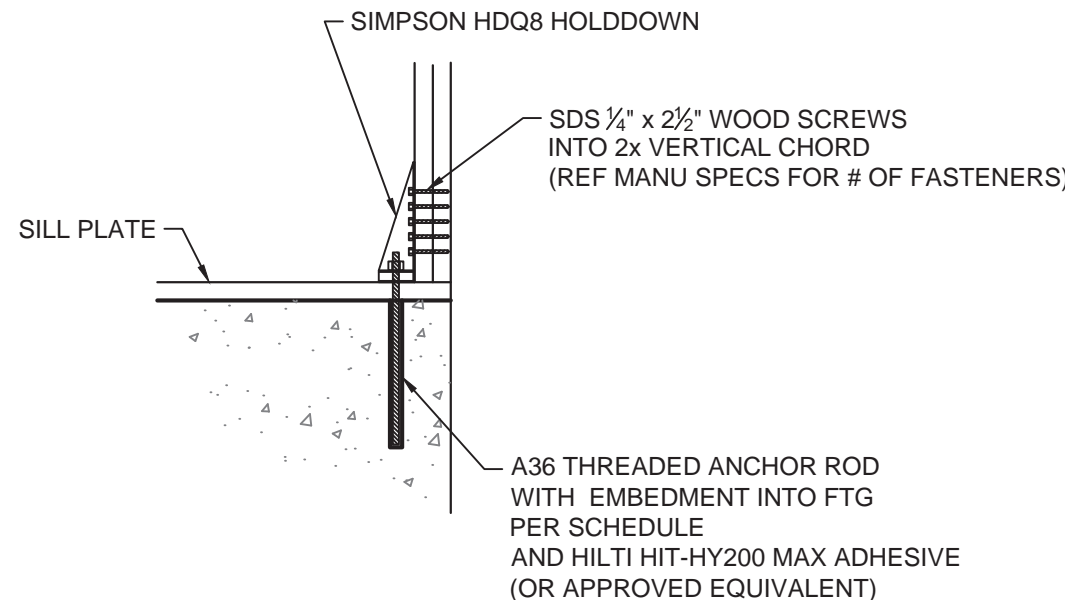

2
S4.0 TYPICAL HOLD DOWN ANCHOR
SCALE: 3/4" = 1'-0"

SHEAR WALL "PANEL" SCHEDULE

PANEL MARK	SHEATHING	BLOCKING REQUIRED	EDGE NAILING	INTERMEDIATE NAILING	TOP PLATE SPLICE CONNECTION	SOLE PLATE NAILING/FASTENING	HOLDDOWN ANCHORS	MIN # OF STUDS EACH END	ALL-THREAD DIA AND EMBEDMENT DEPTH
SW-1	7/16" WSP	YES	8d AT 6"	8d AT 12"	(8) 16d COMMON NAILS	1/2" DIA AT 36" OC	SIMPSON HDU5	2 STUDS	3/4" DIA WITH 7" EMBED INTO FOOTING
SW-2	7/16" WSP	YES	8d AT 3"	8d AT 12"	(8) 16d COMMON NAILS	1/2" DIA AT 36" OC	SIMPSON HDU8	3 STUDS	7/8" DIA WITH 9" EMBED INTO FOOTING

- NOTES:
- HOLDDOWN ANCHORS ARE TO BE INSTALLED USING HILTI HIT-HY 200 MAX ADHESIVE (OR APPROVED EQUAL).
 - THREADED ROD SHALL BE A36 (OR APPROVED EQUAL) WITH EMBEDMENT DEPTH PER SCHEDULE.
 - USE ALL WOOD SCREWS AND/OR LAG SCREWS IN HOLDDOWN DEVICES AS SPECIFIED BY MANUFACTURER.
 - SILL ANCHORS MAY BE CAST-IN-PLACE A36 BOLTS OR EXPANSION BOLTS.
 - WSP = WOOD STRUCTURAL PANEL PLYWOOD OR OSB SEE GENERAL NOTES.

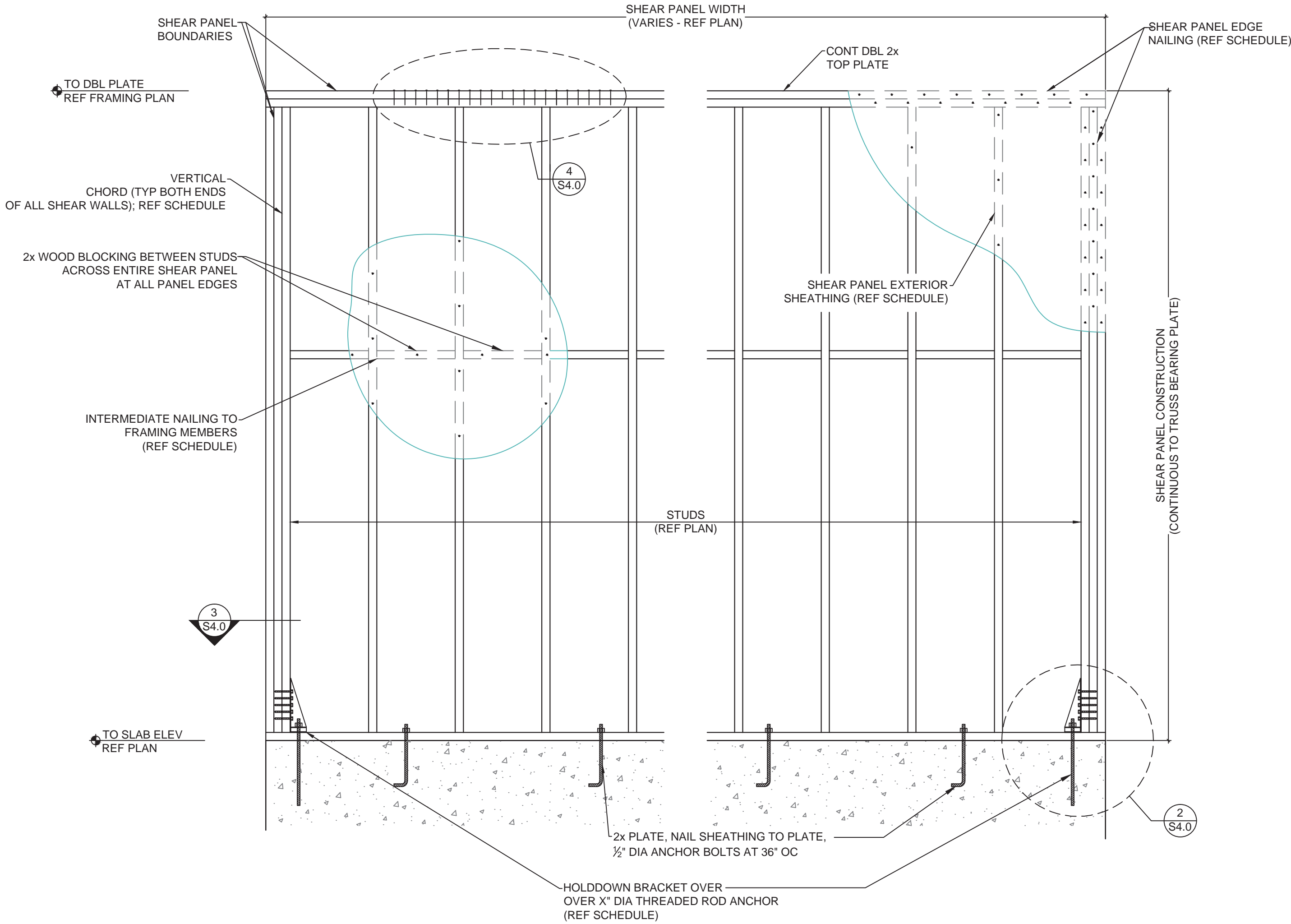

1
S4.0 TYPICAL BRACED WALL FRAMING
SCALE: 3/4" = 1'-0"



THE DESIGN AND DETAILS DISCLOSED HEREIN ARE THE EXCLUSIVE PROPERTY OF DAN WINTER ARCHITECT AND SHALL NOT BE COPIED OR REPRODUCED IN WHOLE OR IN PART WITHOUT ITS PRIOR WRITTEN CONSENT.

DAN WINTER, ARCHITECT

SUBWAY SANDWICH SHOP
2 E. Main St.
Tuttle, Ok. 73089

DAN WINTER ARCHITECT

1024 EAST FIRST STREET
WICHITA, KS. 67214
PH. 316-267-7142

BRACED WALL DETAILS

DATE
NOV. 19, 2015

DRAWN BY:
APEX
CHECKED BY:
BDC

SHEET NO.
S4.0



1600 Baltimore Ave. Suite 102
Kansas City, MO 64108
Ph: 816.421.3222
Fax: 816.421.1050
www.apex-engineers.com